

WARNERVALE TOWN CENTRE

STAGE 6 & 7



DRAWING SCHEDULE

- LDA00 - Cover Sheet
- LDA01 - Site Analysis & Site Plan
- LDA02 - Landscape Concept Plan & Details

LOCATION:

99-121 SPARKS ROAD & 236-260 HOKANE ROAD
WOONGARAH NSW
(Google Maps 2018)

NOT FOR CONSTRUCTION

LANDSCAPE ARCHITECT:		ASPECT:		CLIENT:	PROJECT MANAGER:	PROJECT:		TITLE:		STATUS:		Page:				
<div><div><div><div>conus</div><div>LANDSCAPE ARCHITECTURE</div></div><div><div>Conus Landscape Architecture</div><div>158 Grandview Rd, New Lambton Hts, NSW 2305.</div><div><div>p. 02 4950 9195</div><div>e. info@conuslandscape.com.au</div><div>w. conuslandscape.com.au</div><div>abn. 52 144 562 756</div></div></div></div></div>		<div><div><div><div></div><div>Australian Institute of Landscape Architects</div></div></div></div>		<div><div>N</div><div></div></div>		LIRUN DEVELOPMENTS PTY LTD		<div><div>Colliers</div><div>INTERNATIONAL</div></div>		Warnervale Town Centre Stage 6 & 7		DEVELOPMENT APPLICATION		1/3		
						B 26/02/2020 For submission		Various Lots		SCALE:		DATE:	JOB No:			
						A 25/02/2020 For review		99-121 Sparks Road & 236-260 Hakone Road		NA		26/02/20	17:46 R2			
						REV DATE NOTATION/ AMENDMENT		Woongarah NSW 2259		ISSUE:		DWG No:	PLOTTED:	DRAWN:	CHECKED:	APPROVED:
Registered Landscape Architect: Anton Conus AILA No. 8420						DO NOT SCALE DRAWINGS. CHECK ALL DIMENSIONS. FIGURED DIMENSIONS TAKE PRECEDENCE. THESE DRAWINGS ARE NOT FOR CONSTRUCTION				B		LDA00	1	AS	AC	AC



NOT FOR CONSTRUCTION

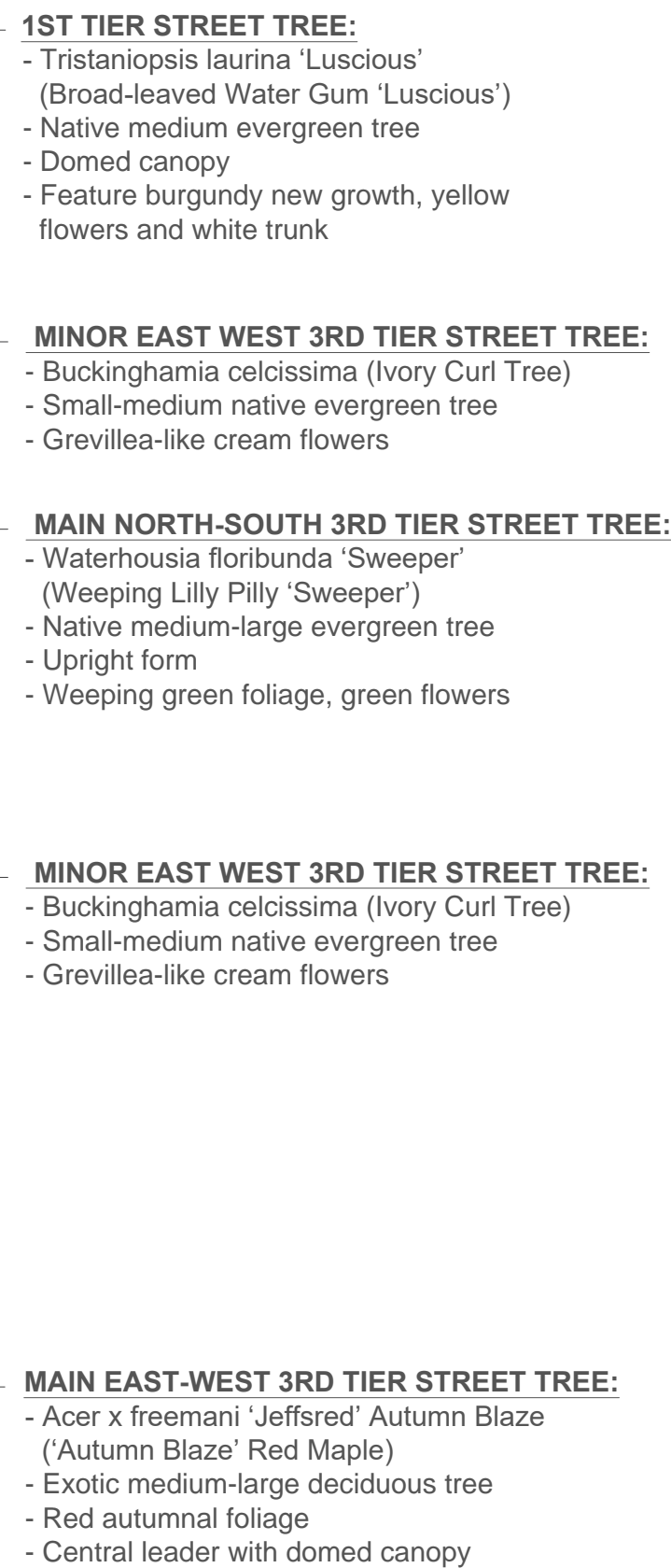

NOTES:

1. All garden beds to contain premium imported garden mix
2. Provide slow-release fertiliser to each plant to manufacturer's instructions
3. All garden beds to contain ANL 'Forest Fines' native timber mulch around trees
4. All trees to be staked by 1800 x 50 x 50mm hardwood timber stakes fastened with hessian ties
5. All trees to comply with NATSPEC specifications
6. Turf to be Kikuyu on 50mm depth top dressing
7. All garden bed edges to be galvanised steel